

**Boston**

home

# KITCHENS

▶▶▶ **What's hot in culinary design these days? Soapstone, butler's pantries, and, of course, plenty of counter space. Turn the page to explore five thoughtfully crafted kitchens that will no doubt inspire your own renovation—and get you cooking.**

BY RACHEL SLADE | PHOTOGRAPHS BY BOB O'CONNOR | STYLING BY CHRISSY BEALE



# MODERN EMBRACE

▶▶▶ A slick addition featuring Italian cabinetry works surprisingly well in this 19th-century Duxbury home.

ARCHITECTURE BY RUHL WALKER ARCHITECTS | BUILT BY ATLANTIC PROPERTIES



## APPLIANCES

**COOKTOP, OVEN, AND WARMING DRAWER** Miele Master Chef Collection. **DISH-WASHER** Bosch built-in. **RANGEHOOD** Miele Designer. **REFRIGERATORS** Sub-Zero refrigerator/freezer and wine refrigerator. All purchased through Arclinea.

## CABINETS

Convivium in graphite laminate, Arclinea.

## COUNTERTOPS AND BACKSPLASH

Ice Flower soapstone, Cumar.

## FLOORING

Oak, Doyle Wood Flooring.

## HARDWARE

Stainless steel handles and toe kicks, Arclinea.

## PAINT

"Atrium White," Benjamin Moore.

## SINK AND FAUCET

Stainless steel undermount sink, Blanco; Tara faucet, Dornbracht.

## SEATING

Barstools, Ikea.



**1**  
**DRAMATIC BACKSPLASH**  
 Book-matched soapstone adds textural contrast to the sleek Italian cabinetry.



**2**



**4**



**3**

A small eating nook, surrounded by windows, overlooks the garden and tennis court.

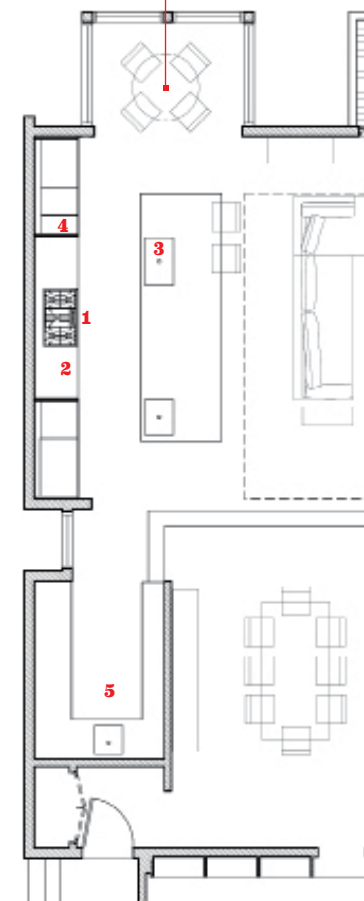

▲ Changing ceiling heights define the kitchen—a dashed line indicates the start of the double-height living room.

## SMART MOVES

- 2 CUSTOM LINERS** Clever drawer inserts keep knives sharp and at-the-ready.
- 3 SMART FIXTURE** With its flexibility and height, the ergonomically designed Dornbracht faucet makes it easy to fill tall pots and clean up after a big dinner.
- 4 SPACE SAVER** Thanks to Arclinea's many cabinetry options, a narrow slot was transformed into a full-depth pullout pantry.
- 5 EXTRA PREP AREA** Guests can brew a cup of coffee or mix a drink in the area adjacent to the kitchen—without bothering the cook.



**5**

### GET THE LOOK

**WELL SET**  
 Sabre  
 Baguette  
 five-piece  
 place setting,  
 \$128, Didriks.



**WISE CHOICE**  
 littala Taika  
 espresso  
 saucer, \$14,  
 Didriks.



**UNDER THE SEA**  
 John Derian  
 Seaweed #21  
 tray, \$180,  
 Lekker Home.

